



Banyan Tree Realty

Site Address

46 Banyan tree
Gat no 135, 136, 137
Pachane Road Chandkhed,
Taluka Maval.
Pune - 410506

+91-7026996600

sales@banyantreerealty.in

46banyantree.in

RERA NO. P52100018777



46 BANYAN TREE



An architectural rendering of an outdoor amphitheatre. The scene is set in a lush, green environment with numerous trees and plants. In the foreground, there are concrete planters filled with various green and yellow plants. A wide, paved walkway leads towards a central lawn area. In the middle ground, there are several long, low concrete benches arranged in a semi-circle. In the background, a modern building with large glass windows is visible, partially obscured by trees. The sky is clear and blue, suggesting a bright, sunny day.

Experience a heavenly and an exquisite joy of living.



Architectural rendition of Piazza.

SOOTHING. SUBLIME. STUNNING.

Our living spaces are scintillating, spacious and enable you to honour the special relation we have with nature.

Welcome to 46 Banyan Tree,
a tribute to the precious gifts of nature.



Architectural rendition of Layout.

ABOUT

Spread across 46 acres, and surrounded by lushness, 46 Banyan Tree is a PMRDA approved, secured gated community living with residential villa plots ranging from 3,600-6,000 sq. ft., with each plot having an FSI of 1.5 with drinking water and electricity connection.

It is located in Chandkhed near Hinjewadi on a proposed 36M road which connects Hinjewadi to the Mumbai-Pune Expressway.

Crafted by one of New Zealand's most renowned architects, the project boasts of vast open spaces, expansive greenery and amenities of world-class quality.

Come and experience a life that is truly pristine in every way.



Architectural rendition of Entrance.

PROJECT HIGHLIGHTS

Live amidst utmost serenity and tranquillity at 46 Banyan Tree, where every element has been designed to promote a wonderful and a nature-friendly lifestyle.

- Pristine and secured gated community
- Plot FSI of 1.5
- Internal concrete roads lined with trees on both the sides
- Electricity connection provided to every plot
- Advanced water treatment plant
- Entrance plaza with security
- Over 3.5 acres of vast open spaces
- Central Open Space equipped with variety of activities for health and entertainment such as barbecue zones, yoga zone, outdoor chess arena and children's play area
- Clubhouse spread over an area of 10,000 sq. ft. containing gymnasium, society office, multipurpose hall and other activity centres
- Organic farms and gardens to indulge in nature conservation activities
- LED streetlights lining the walkways
- Sustainable groundwater recharge pits
- Multipurpose sports court & 3 km walking / jogging track



Architectural rendition of Internal Roads.

YOUR OWN PARADISE

Live in a world where nature and modernity co-exist in an ideal symbiotic relationship. Here, the polished concrete roads are canopied by lush green trees on both sides and each road is lined with a different type of tree so as to put a spotlight on the beauty of diversity nature provides us with. Additionally, 46 Banyan Tree is full of nature's wonders, with various species of fruiting and flowering trees decorating every corner of this paradise.

The groundwater recharge pits add a charm to our goal of making this community conservation-friendly. You can also get a chance to explore the various forms of conservational activities such as organic farming.



Architectural rendition of Multipurpose Court.

THE CENTRE OF ENTERTAINMENT

Enhance your living experience with the various activities available at the Central Open Space, such as the amphitheatre where you can celebrate the spirit of your community, impeccable barbecue stations and piazzas for a perfect weekend brunch, an outdoor chess arena for the ultimate battle of wits, a yoga zone that is perfect for your morning meditations and calming lush lawns which are not only the perfect meetings zones but also a great place to relax.

The Central Open Space at 46 Banyan Tree is where the community comes together to celebrate life!



YOUR WELL-BEING WISHLIST

At 46 Banyan Tree the amenities have a diverse mix of fitness and recreational facilities so as to give you a holistic approach to the well-being of your mind, body and soul.

46 Banyan Tree offers you a range of spaces that would aid one in leading a holistic lifestyle. From serene infinity edge pool where you can refresh after a busy day, to a multipurpose court where you can challenge your friends for a match or two, there's something for everyone. Give your little ones an entertaining evening at the children's play area, spend time with your neighbours in the indoor games arena, or simply take a run on the jogging track.

At 46 Banyan Tree, your well-being is not only an additive but also the very essence of your life.

An architectural rendering of a modern clubhouse. The building features a two-story design with a ground floor of large glass windows and a second floor with vertical wooden slats. In the foreground, there is a large swimming pool with a waterfall edge. The pool is surrounded by a paved deck with lounge chairs and several tall palm trees. The background shows more lush greenery and a clear blue sky.

Recreation Within Your Reach

RECREATION WITHIN YOUR REACH

The clubhouse at 46 Banyan Tree is home to both the prolific amenities and activities that boost community living.

From planning your gym schedule, to organizing big and small events, the clubhouse is the string that knits our community together.

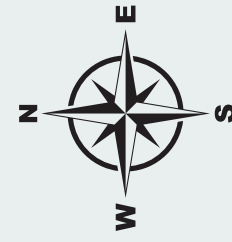

46 BANYAN TREE

Site Layout

CENTRAL OPEN SPACE

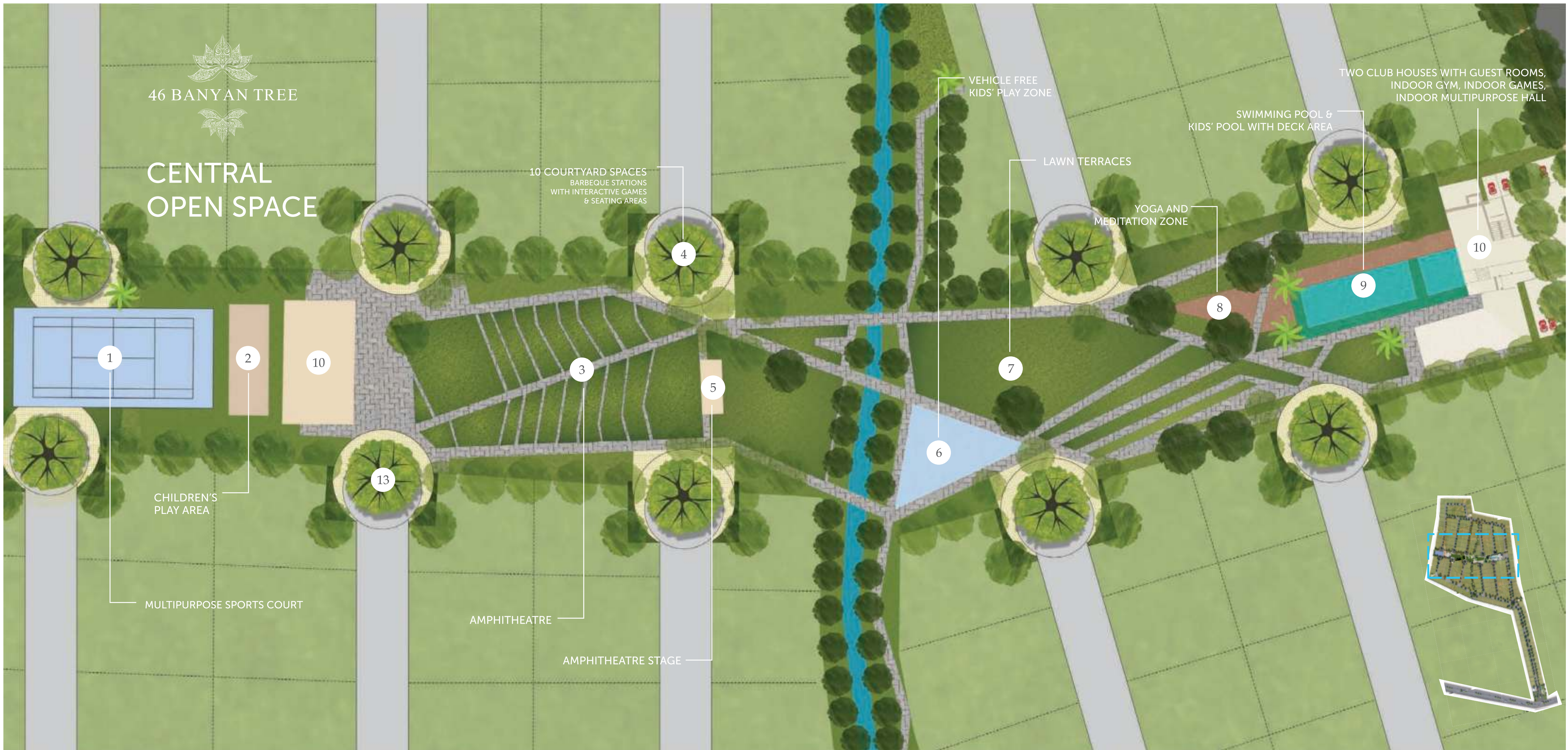

10 COURTYARD SPACES
BARBEQUE STATIONS
WITH INTERACTIVE GAMES
& SEATING AREAS

VEHICLE FREE
KIDS' PLAY ZONE

TWO CLUB HOUSES WITH GUEST ROOMS,
INDOOR GYM, INDOOR GAMES,
INDOOR MULTIPURPOSE HALL

SWIMMING POOL &
KIDS' POOL WITH DECK AREA

LAWN TERRACES

YOGA AND
MEDITATION ZONE

CHILDREN'S
PLAY AREA

MULTIPURPOSE SPORTS COURT

AMPHITHEATRE

AMPHITHEATRE STAGE



LOCATION MAP

46 Banyan Tree is located in Chandkhed, a fast-developing area located about 10 kilometers away from Hinjewadi. The location of the project makes it easily accessible to areas of prime interests such as the Pune-Mumbai Expressway, Hinjewadi IT Park, and various schools and hospitals.



Connectivity

Mumbai-Pune Expressway
8 Kms away

Wakad
13 Kms away

IT Park Hinjewadi
10 Kms away

University Circle
25 Kms away

Somatane Phata
12 Kms away

+ Hospitals

Pawana Hospital
Ayushree Hospital

📖 Schools / Universities

BoB- Priman International School (BPIS)
Kirloskar Institute of Management Studies
Indira Global Business School
AIMS Institute of Management Studies

